



PulseQ

AC Home **EU Version**

- Unlimited Power
- Unlimited Versatility
- Unlimited Potential

TOPDON's PulseQ is the first of TOPDON's EV charging stations. Offering versatility, adaptability, and smart technology to users, the PulseQ makes EV charging widely accessible. The PulseQ is compatible with most European AC electric vehicles because of the IEC62196-2 Type 2 , eliminating most brand barriers to electric vehicle owners. The compact design and multiple mounting options save space in garages, and can even be mounted outside to take up no interior space. The charging station's interface can be accessed and adjusted through an app to set charging sessions during off-hours and to monitor the charging process.

Spec:

Phase Number:	Model:	AC Power Input /Output Voltage:	AC Power Input /Output Current:
3-Phase	PulseQ AC Home 22KW	400VAC, 50 / 60Hz	32/16A
1-Phase	PulseQ AC Home 11KW	230VAC, 50 / 60Hz	32A
	PulseQ AC Home 7KW		
Connector Type:	Charging Cable Length:		
IEC 62196-2 Type 2	5M (7.5m cable is optional)		
Dimension:	Weight:		
310 x 215x95 mm	7~8KG		
Storage Temp:	Operating Temp:		
-40 ~ 75 °C	-30 ~ 55 °C		

Features:

- Safety And Durable with CE, LVD, RED, RoHS Certification and Passed REACH testing
- Three Charging Modes, RFID Reader, Plug and Play, App Control
- Build-In Multi-Protections and with IP65 Rating
- Compact Design to Save Space
- Easy Installation with Multiple Mounting Options
- Compatible With Most European AC Electric Vehicles

What's in the Box:

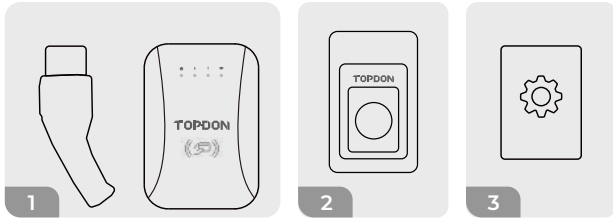

- 1 PulseQ Charger (Including charging gun and Wall Mount Accessories)
- 2 Cable Holder Socket
- 3 User Manual (Include Charging Card)